

CABRA INVESTMENTS LIMITED

AS-BUILT PLANS 56 LOT RESIDENTIAL SUBDIVISION (STAGES 1-3) 202 & 212 MATUA ROAD, HUAPAI R65429 RDC21584 #44397



PRELIMINARY & GENERAL

PG101	COVER SHEET
PG102	EXISTING CONTOUR PLAN
PG103	ASBUILT CONSENT NOTICE PLAN 1
PG104	ASBUILT CONSENT NOTICE PLAN 2
PG105	ASBUILT COORDINATE TABLES

EARTHWORKS

EW201	ASBUILT CONTOUR PLAN
EW202	ASBUILT CUT & FILL DEPTH CONTOUR PLAN
EW203	ASBUILT UNDERCUT DEPTH CONTOUR PLAN

ROADING

RD301	ASBUILT ROADING PLAN 1
RD302	ASBUILT ROADING PLAN 2
RD303	ASBUILT ROAD CROSS SECTIONS

STORMWATER

SW401	ASBUILT STORMWATER PLAN 1
SW402	ASBUILT STORMWATER MANHOLE PLAN 1
SW403	ASBUILT STORMWATER PLAN 2
SW404	ASBUILT STORMWATER MANHOLE PLAN 2
SW405	ASBUILT STORMWATER PLAN 3
SW406	ASBUILT STORMWATER MANHOLE PLAN 3
SW407	ASBUILT STORMWATER PLAN 4
SW408	ASBUILT STORMWATER MANHOLE PLAN 4

WASTEWATER

WW501	ASBUILT WASTEWATER PLAN 1
WW502	ASBUILT WASTEWATER PLAN 2

WATER SUPPLY

WS601	ASBUILT OVERALL WATER SUPPLY PLAN
WS602	ASBUILT WATER SUPPLY PLAN 1
WS603	ASBUILT WATER SUPPLY PLAN 2
WS604	ASBUILT WATER SUPPLY PLAN 3
WS605	ASBUILT WATER SUPPLY PLAN 4



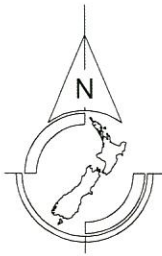

REV.	DESCRIPTION	CHECK	APPD	DATE	SCALE	1:2000 AT A3
					NAME	DATE
					MJ	09.16
					MJ	09.16
					PF	09.16
					PF	09.16
					EP	09.16

CLIENT
CABRA DEVELOPMENTS LIMITED

Conditions of Use:
 These drawings shall only be used for the purpose for which they were supplied. Do not measure off this drawing. If doubt please contact Engineer.

SITE ADDRESS
**56 LOT RESIDENTIAL SUBDIVISION (STAGES 1 TO 3)
 202 & 218 MATUA ROAD, HUAPAI
 R65429 RDC21584**

DRAWING TITLE
EXISTING CONTOUR PLAN

DRAWING NUMBER
1138 - AB - PG102

DATE
SEPT 2016

REVISION
 -

ASPIRE
 CONSULTING ENGINEERS

Ph: 09 426 6552
 Web: www.aspeng.co.nz

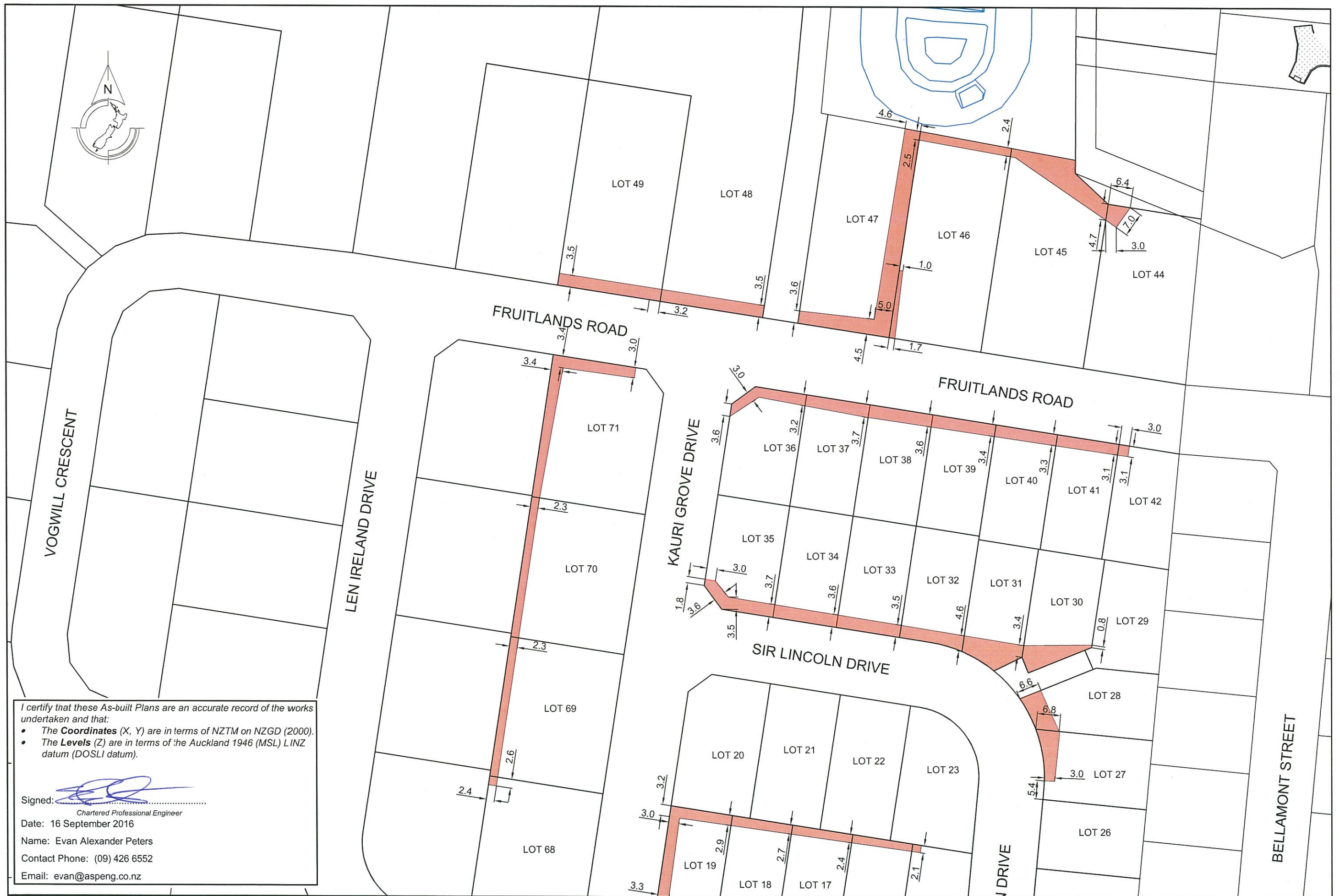

I certify that these As-built Plans are an accurate record of the works undertaken and that:

- The **Coordinates** (X, Y) are in terms of NZTM on NZGD (2000).
- The **Levels** (Z) are in terms of the Auckland 1946 (MSL) LINZ datum (DOSLI datum).

Signed: 
 Chartered Professional Engineer

Date: 16 September 2016
 Name: Evan Alexander Peters
 Contact Phone: (09) 426 6552
 Email: evan@aspeng.co.nz

REV.	DESCRIPTION	CHECK	APPD	DATE	SCALE	1:1000 AT A3
	DESIGN			09.16		
	DRAWN			09.16		
	DRAWING CHECK			09.16		
	DESIGN CHECK			09.16		
	APPROVED			09.16		

CLIENT
CABRA DEVELOPMENTS LIMITED

Conditions of Use:
 These drawings shall only be used for the purpose for which they were supplied. Do not measure off this drawing. If doubt please contact Engineer.

SITE ADDRESS
**56 LOT RESIDENTIAL SUBDIVISION (STAGES 1 TO 3)
 202 & 218 MATUA ROAD, HUAPAI
 R65429 RDC21584**

DRAWING TITLE
ASBUILT CONSENT NOTICE PLAN 1

DRAWING NUMBER
1138 - AB - PG103

DATE
SEPT 2016

REVISION
 -



Ph: 09 426 6552
 Web: www.aspeng.co.nz

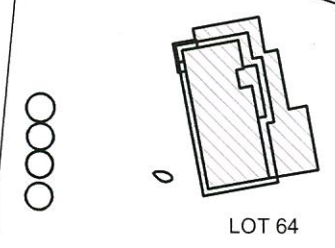

I certify that these As-built Plans are an accurate record of the works undertaken and that:

- The **Coordinates** (X, Y) are in terms of NZTM on NZGD (2000).
- The **Levels** (Z) are in terms of the Auckland 1946 (MSL) LINZ datum (DOSLI datum).

Signed: 
 Chartered Professional Engineer
 Date: 16 September 2016
 Name: Evan Alexander Peters
 Contact Phone: (09) 426 6552
 Email: evan@aspeng.co.nz

REV.	DESCRIPTION	CHECK	APPD	DATE	SCALE	1:1000 AT A3	CLIENT	SITE ADDRESS	DRAWING NUMBER	
							CABRA DEVELOPMENTS LIMITED	56 LOT RESIDENTIAL SUBDIVISION (STAGES 1 TO 3) 202 & 218 MATUA ROAD, HUAPAI R65429 RDC21584	1138 - AB - PG104	
					DESIGN	MJ				09.16
					DRAWN	MJ				09.16
					DRAWING CHECK	PF				09.16
					DESIGN CHECK	PF				09.16
					APPROVED	EP	09.16			
Conditions of Use: These drawings shall only be used for the purpose for which they were supplied. Do not measure off this drawing. If doubt please contact Engineer.								DRAWING TITLE ASBUILT CONSENT NOTICE PLAN 2	DATE SEPT 2016	REVISION -



Ph: 09 426 6552
 Web: www.aspeng.co.nz

ASBUILT CO-ORDINATE TABLES

STORMWATER MANHOLE

COORDINATES		
POINTS	EASTING	NORTHING
ABSW-WWA0	1736755.886	5930636.317
ABSWMHA01	1736750.063	5930628.556
ABSWMHA02	1736740.854	5930570.806
ABSWMHA03	1736735.803	5930549.454
ABSWMHA04	1736703.825	5930555.227
ABSWMHA05	1736697.089	5930550.613
ABSWMHA06	1736688.011	5930499.194
ABSWMHA07	1736692.969	5930492.916
ABSWMHA08	1736689.317	5930472.277
ABSWMHA09	1736682.973	5930467.772
ABSWMHA10	1736676.848	5930434.182
ABSWMHA11	1736671.764	5930402.727
ABSWMHA12	1736677.597	5930394.479
ABSWMHA13	1736673.881	5930373.616
ABSWMHA14	1736665.795	5930367.370
ABSWMHA15	1736660.603	5930338.701
ABSWMHA16	1736639.810	5930349.766
ABSWMHA17	1736578.744	5930360.038
ABSWMHB01	1736715.313	5930575.164
ABSWMHB02	1736675.513	5930582.160
ABSWMHC01	1736671.372	5930560.636
ABSWMHC02	1736646.049	5930564.462
ABSWMHE01	1736638.798	5930523.907
ABSWMHE02	1736624.805	5930443.215
ABSWMHF01	1736809.349	5930535.858

STORMWATER MANHOLE

COORDINATES		
POINTS	EASTING	NORTHING
ABSWMHG01	1736776.906	5930477.920
ABSWMHG02	1736787.179	5930454.312
ABSWMHG03	1736778.207	5930382.325
ABSWMHG04	1736783.908	5930354.497
ABSWMHG05	1736777.832	5930318.249
ABSWMHH01	1736744.953	5930360.932
ABSWMHI01	1736747.211	5930462.052
ABSWMHJ01	1736747.050	5930422.070
ABSWMHK01	1736707.262	5930367.662
ABSWMHL01	1736681.431	5930335.364
ABSWMHL02	1736718.767	5930328.807
ABSWMHM01	1736780.938	5930621.912
ABSWMHN01	1736675.574	5930301.056

STORMWATER CESSPIT

COORDINATES		
POINTS	EASTING	NORTHING
ABSWCP01	1736710.888	5930567.607
ABSWCP02	1736674.254	5930573.813
ABSWCP03	1736710.305	5930560.713
ABSWCP04	1736683.927	5930561.005
ABSWCP05	1736689.934	5930485.793
ABSWCP06	1736688.928	5930479.373
ABSWCP07	1736668.629	5930467.466
ABSWCP08	1736675.479	5930466.468
ABSWCP09	1736658.391	5930367.870
ABSWCP10	1736651.504	5930369.178
ABSWCP11	1736665.023	5930295.916
ABSWCP12	1736777.587	5930466.375
ABSWCP13	1736771.741	5930440.039
ABSWCP14	1736777.819	5930435.348
ABSWCP15	1736741.193	5930375.638
ABSWCP16	1736739.877	5930369.257
ABSWCP17	1736577.381	5930358.912

FIRE HYDRANT

COORDINATES		
POINTS	EASTING	NORTHING
ABWSFH01	1736709.566	5930573.898
ABWSFH02	1736664.124	5930475.336
ABWSFH03	1736762.957	5930453.597
ABWSFH04	1736746.210	5930380.329
ABWSFH05	1736620.719	5930384.739

WASTEWATER FLUSHING PIT

COORDINATES		
POINTS	EASTING	NORTHING
ABWWFP01	1736811.598	5930555.729
ABWWFP02	1736645.301	5930584.527

REV.	DESCRIPTION	CHECK	APP'D	DATE	SCALE	N.T.S.	CLIENT	SITE ADDRESS	DRAWING NUMBER
							CABRA DEVELOPMENTS LIMITED	56 LOT RESIDENTIAL SUBDIVISION (STAGES 1 TO 3) 202 & 218 MATUA ROAD, HUAPAI R65429 RDC21584	1138 - AB - PG105
					DESIGN				
					DRAWN				
					DRAWING CHECK				
					DESIGN CHECK				
					APPROVED				
							Conditions of Use: These drawings shall only be used for the purpose for which they were supplied. Do not measure off this drawing. If doubt please contact Engineer.	DRAWING TITLE	DATE
								ASBUILT CO-ORDINATE TABLES	SEPT 2016
									REVISION
									-

